



Milsom Place

3 & 4 Milsom Place, Bath, BA1

- Prominent building in established food destination
- 52 ft frontage to courtyard with external seating
- 890 sq ft internal & 350 sq ft external space in total

The historic streets that comprise the Milsom area of Bath are perfectly situated; sandwiched between the affluent residential areas to the north and the modern commercial zone to the south, this vibrant central area represents the best of Bath's shopping. The majority of the city's restaurant brands are also located in Milsom and their operations here invariably trade amongst their best in the UK.

Milsom Place lies at the heart of this stylish area. Its lively streets and courtyards have been a catering destination in Bath for over 20 years and known not only for its food and fashion but also for hosting events, festivals and exhibitions. Such a large and enclosed pedestrianised environment is unique in Bath and it is a magnet for residents, workers, shoppers and tourists alike.



Accommodation

The ground floor of a prominent centrally located listed building with frontages both to the open courtyard to the north and a covered walkway to the south. 3 & 4 Milsom Place are available separately or together – planning consent will be required to link the two.

3 Milsom Place

Gross Internal: 347sq ft
Gross Depth: 100 sq ft

4 Milsom Place

Gross Internal: 535sq ft
Gross Depth: 350 sq ft

Lease

Available on a new lease for a term to be agreed, excluded from the provisions of the Landlord and Tenant Act 1954 (part II) as amended.

Rent

On application.

Rates

We are verbally informed by the Local Rating Authority that the unit is assessed for rating purposes as follows:

Rateable Value:

3 Milsom Place £16,758 p.a.

4 Milsom Place £26,000 p.a.

Rates Payable (2011/2012):

3 Milsom Place £7,252 p.a.

4 Milsom Place £11,258 p.a.

Interested parties are advised to make their own enquiries with the Local Rating Authority.

Contact/Viewing

CWM agent

Xhola McKoy

020 7494 6919

Xhola.mckoy@cwm.co.uk

Rebecca Jeans

020 7494 6929

rebecca.jeans@cwm.co.uk

King Sturge agent

Mike McElhinney

01225 324107

mike.mcelhinney@kingsturge.com

Allan Lloyd

01225 324111

Allan.lloyd@kingsturge.com

L&R Group landlord

Ken Elliott

01225 789 199

kelliott@lrgroup.co.uk



Milsom Place

3 and 4 Milsom Place, Bath, BA1



Milsom Place

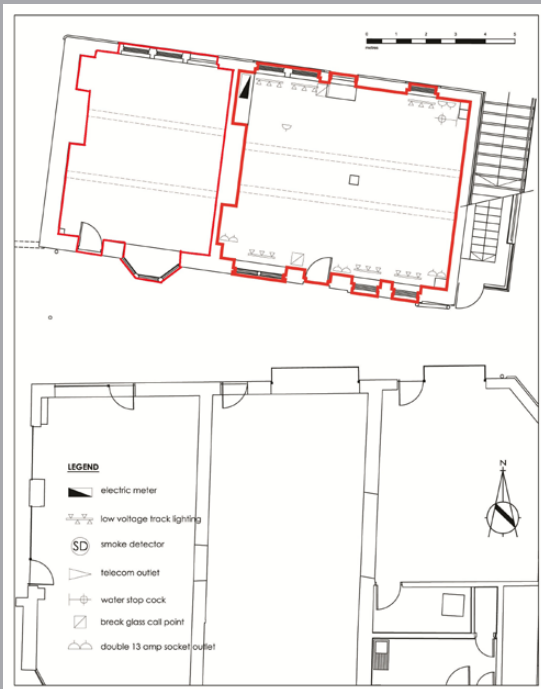

In the neighbourhood

Reiss
Jamie's Italian
Cath Kidston
Ted Baker
House of Fraser
Côte Brasserie

Comptoir de Cotonniers
Toast
Gieves and Hawkes
Phase Eight
TM Lewin
Wagamamas

Jack Wills
White Stuff
French Connection
YO! Sushi
Space NK
Loch Fyne

Jigsaw
White Company
Gap
Waterstones
Karen Millen
LK Bennett

Hobbs
Russell & Bromley
Molton Brown
Brora
Goldsmiths
Coast